

Twyford Avenue, Portsmouth

Approximate Gross Internal Area = 42.8 sq m / 460 sq ft

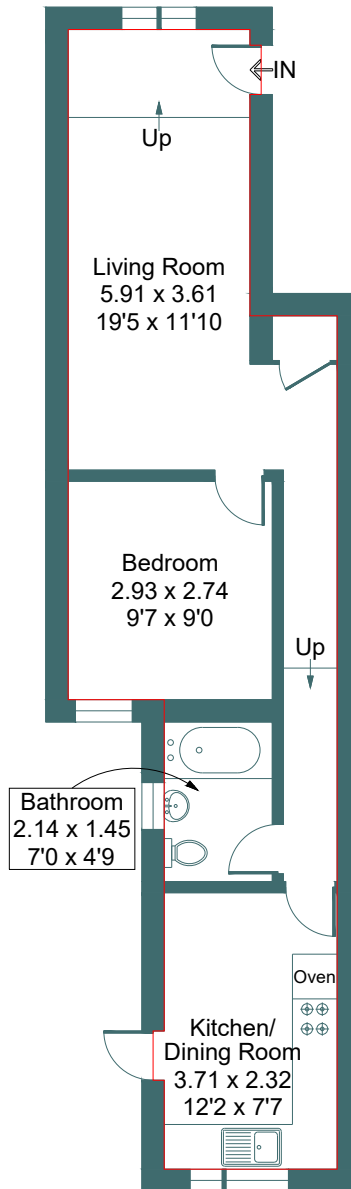
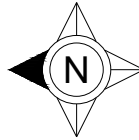

Ground Floor

This plan is for layout guidance only. Not drawn to scale unless stated. Windows and door openings are approximate. Whilst every care is taken in the preparation of this plan, please check all dimensions, shapes and compass bearings before making any decisions reliant upon them.